

Item	Description	HP Part No.	Qty.
1	Cover	19233- 00085	1
2	Anode/Ferrule/Nut Assembly	19233- 67010	1
3	● Anode Weldment	19233-80585	1
4	● Anode Retaining Nut	19233-20725	1
5	● Anode Ferrule	19233- 20695	1
6	ECD Cover	19233- 00075	1
7	Screw	0515- 0964	2
8	Upper Heater Block	19233- 20525	1
9	Screw-Socket M4 x 0.7	0515-0321	4
10	Upper Cell Weldment	19233-80525	1
11	Plated Lower Body	not available*	1
12	Mounting Strap	19231- 00145	1
13	ECD Flange Insulation	19233- 40015	1
14	Bottom Insulation	19233- 40016	1
15	Lower Heater Block	19233- 20515	1
16	Heater/Sensor Assy	19233- 60625	1
17	● PRT Sensor	19231- 60660	1
18	● Contact	1251- 5963	2
19	● Heater, 60 W	19233- 60627	1
20	● Contact	1251- 1679	2
21	● Flexible Sleeving (ordered by the inch)	0890- 0737	22
22	Adapter (Refer to Figure 7)		
23	Interconnect Lead	19233- 60635	1
24	Interconnect Assembly	19233- 60600	1
25	Hex Nut, M3	0535- 0407	3
26	Lock Washer	2190- 0407	3
27	Thermal Cover Clip	19233- 00095	1
28	Screw	0515- 0910	1

\* = restricted article; replace entire detector:

General License - 19233- 69576

Specific License - 19235- 69536

**Figure 5. G1223A/G1224A Electron Capture Detector (ECD) (Sheet 1 of 2).**

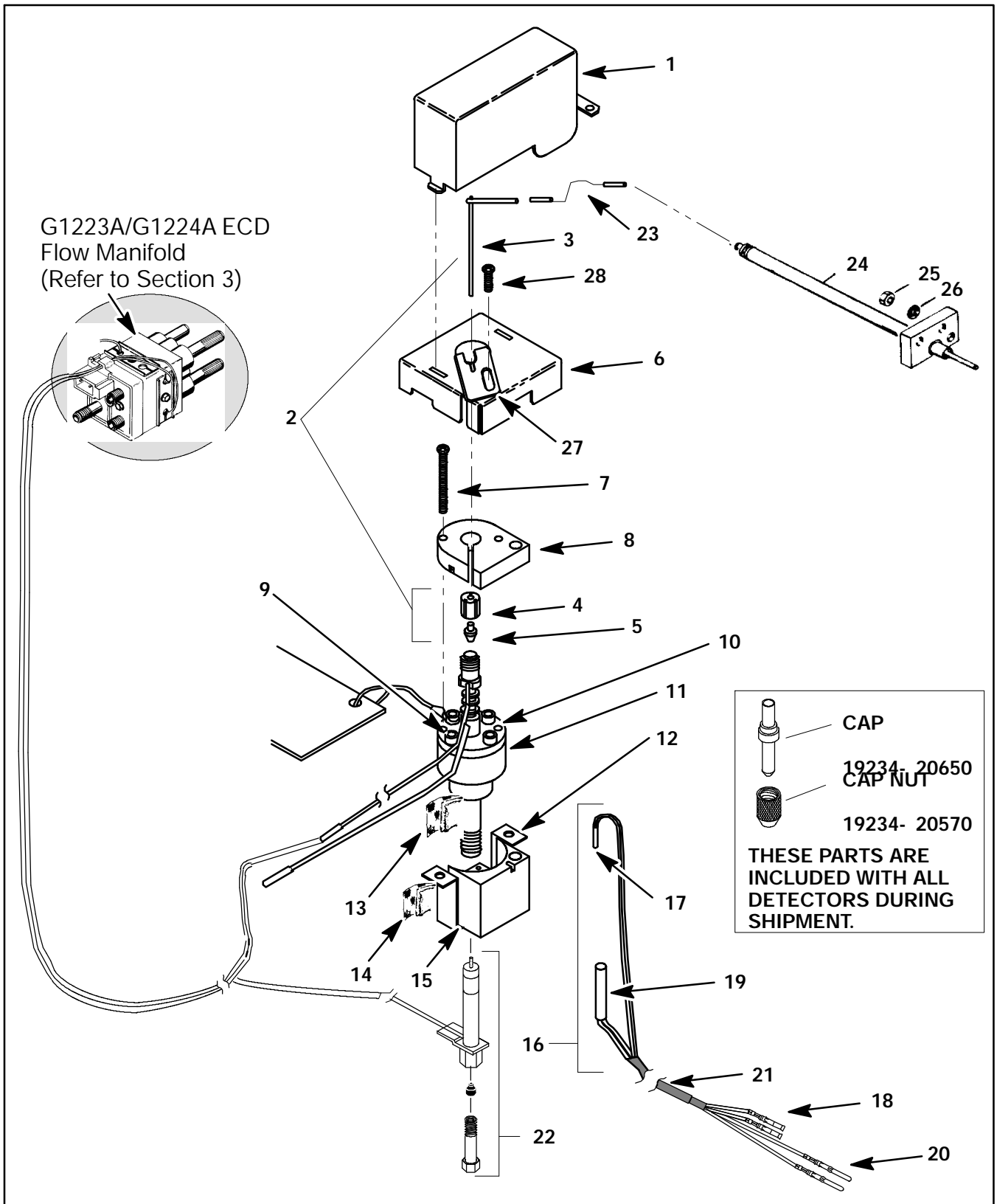

**Figure 5. G1223A/G1224A Electron Capture Detector (ECD) (Sheet 2 of 2).**